

Connected Latching Relay

4 121 70 - 1 991 21



Requires the installation of a:

Gateway module

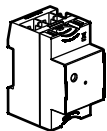

OR

Connected Starter Pack
"... with Netatmo"



OR

Any kind of
"with Netatmo"
gateway

Composition

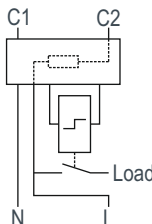
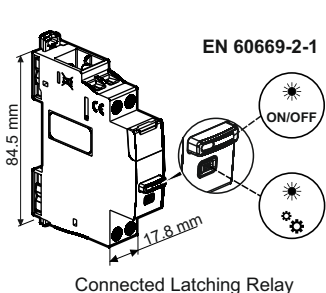

Control wiring authorized

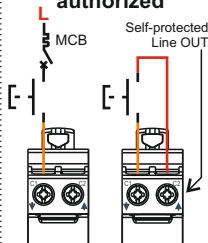

| | | | | | | | | | |
|---------------|----------------------|----------|-------------------------------|------------------|----------|---------|-------|---------------------------|-------|
| | U | I | F | | | | | LED FLUO | |
| -5°C +45°C | 100-240V~ 50/60Hz | 16A MAX | 2,4 à 2,4835Ghz <100 mW | Silent < 10dB | Planning | Measure | 3840W | 650W | 3000W |

Imperative security precaution

The instructions for installation and use must be strictly observed in order to avoid the risk of electric shock or fire.



1 Preparation, connection

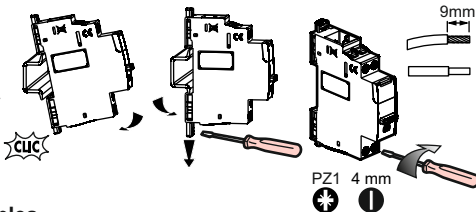
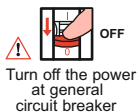

| |
|--|
| C1, C2: MAX 2x 1.5mm ² 2.5mm ² |
| N, L, Load: MAX 2x 2.5mm ² 6mm ² |
| C1, C2, N, L, Load: MIN : 0.8Nm MAX : 1.4Nm |

Wiring examples

Do not use a switch (with dimmer option) connected to control a Connected Latching Relay.

The control circuit (upstream terminals C1 and C2) have an integrated power and an integrated protection.

For the protection of the Connected Latching Relay, it is recommended to use a circuit breaker or a gG fuse with current rating $\leq 16A$.

Wired installation

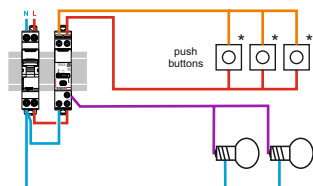

Wired installation with junction box

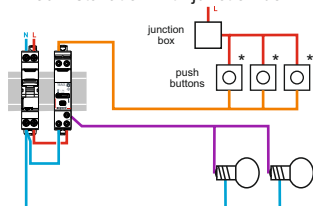

Mixed wired and wireless installation

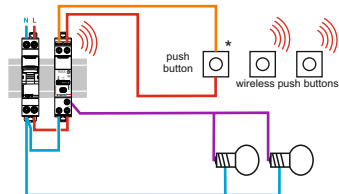

Wireless installation

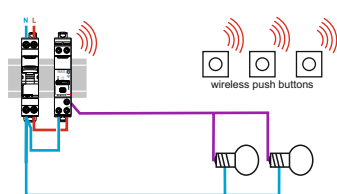

* : Non-functional indicator lights on push-buttons with indicator lights with connected latching relay

— N (neutral) = blue — L (Line) = everything but blue and green/yellow
 — Line after contact = usually purple, orange...

Tips: in case of replacement of an old push button by a wireless control, isolate wires that are no longer used.



2 Add the Latching Relay in a connected installation

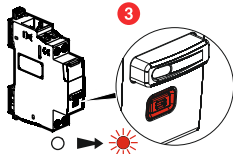
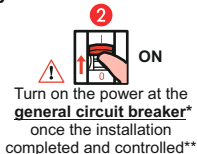
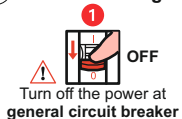

* In order to restart all connected products at the same time.

** : After wiring the installation, refit the front plate so that no active live part is accessible.

3 Finalize the installation in the Legrand Home + Control app

Download the Home + Control App and follow the instructions for adding the connected product in your setup.

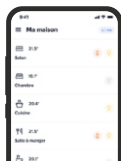

You also have the option of controlling your installation via a voice assistant. and can customize your scenarios via the Home + Control App.



Use by manual control and status LED

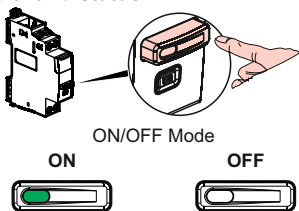

Wireless push button resetting

Press and hold the center of the push button until the LED lights up in orange, then briefly press on the center to confirm the reset.



legrandaruhaz.hu

Reset a Connected Latching Relay to remove it from a connected installation

Press the configuration button of the Connected latching relay (> 5 seconds) until the configuration indicator lights up in fixed red. It is no longer associated with the gateway present in the installation.

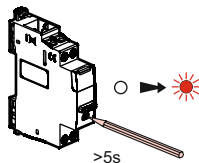

www.legrand.fr/reference/412170

LEGRAND - Pro and Consumer Service - BP 30076
87002 LIMOGES CEDEX FRANCE • www.legrand.com

UE SIMPLIFIED DECLARATION OF CONFORMITY

The undersigned,

Legrand

declares that the radio equipment listed on this instruction sheet
are compliant to the directive 2014/53/UE.

The full text of the UE declaration of conformity
is available at the following website:

www.legrandoc.com

legrandaruhaz.hu