

Plexo™ Emergency stop functions

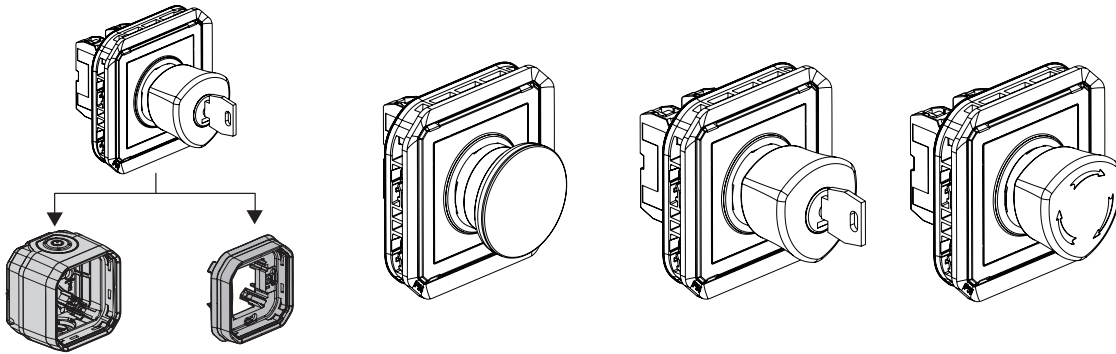

Cat. No(s): 0 695 47L/48L/49L



1. USE

Waterproof equipment system intended for residential and professional technical locations (garages, cellars, car parks, workshops and industrial kitchens, etc.) as well as outdoor environments (terraces, gardens, campsites, etc.).
Emergency stop functions.

2. RANGE

	References: Designations
Configurable	 0 695 47L : Emergency stop button 1 NC contact
	 0 695 48L : Emergency stop with key for reset NO + NC contact
	 0 695 49L : Emergency stop stay put 1/4 for reset NO + NC contact

3. OVERALL DIMENSIONS (mm)

■ 0 695 47L

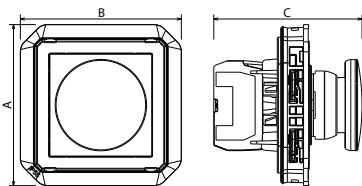

■ 0 695 48L

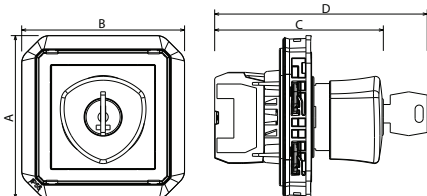

■ 0 695 49L

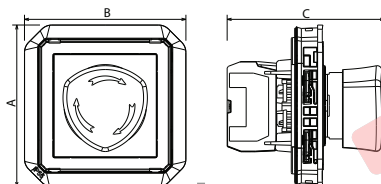

3. OVERALL DIMENSIONS (mm) (continued)

	A	B	C	D
0 695 47L	70.5	70.5	65	-
0 695 48L	70.5	70.5	73	92
0 695 49L	70.5	70.5	68.75	-

4. CONNECTION

Type of terminals: screw
Terminal capacity: 1.5 mm² - 2.5 mm² (1 or 2 conductors)
Stripping length: 8 mm

5. TECHNICAL CHARACTERISTICS

■ 5.1 Protection index

Protection against solid bodies and liquids: IP 55
Protection against impact: IK 07

■ 5.2 Material characteristics

Support : PC + SEBS
Mechanism: PC

UV-resistant
Halogen-free

Resistance to salt spray: 7 days (168 h)

Self-extinguishing:
850°C/30 s for insulating components holding live parts in place.
650°C/30 s for other insulating components.

■ 5.3 Electrical characteristics

Voltage: 250 V~
Frequency: 50 Hz
Current: 3 A

■ 5.4 Climate characteristics

Usage temperature: - 10° à + 40° C
Storage temperature: - 25° C à + 60° C

Emergency stop functions

6. CLEANING

Surface cleaning with a cloth.

Do not use: acetone, tar remover, trichloroethylene.

Maintenance with the following products: Hexane (EN 60669-1), Methylated spirit, Soapy water, Diluted ammonia, Bleach diluted to 10%, Window-cleaning products, Pre-saturated wipes.

Caution: A preliminary test should be carried out if other specific cleaning products are to be used.

7. STANDARDS AND APPROVALS

Compliance with standards of installation and manufacturing.
Refer to e. catalogue.