

Céliane™

6 A Pushbuttons switches

Cat. No(s): 0 770 33/35/36

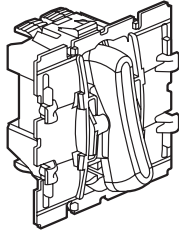

0 670 33

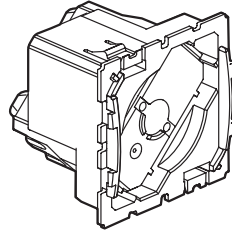

0 670 35

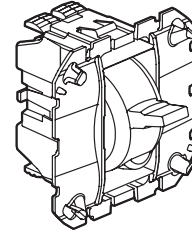

0 670 36

1. USE

General lighting mechanisms.
 Vertical and horizontal multi-gang mounting.
 Can be fitted with the full range of Céliane finishes.

2. RANGE

	Description	Reference
	Silent pushbutton - 1-gang Possibility of realizing a double push-button in 1-gang (divisible product).	0 670 33
	"Push type" pushbutton- 1-gang It is not possible to make a double pushbutton in a 1-gang version.	0 670 35
	"Lever type" pushbutton- 1-gang Possibility of realizing a double push-button in 1-gang (divisible product).	0 670 36

3. OVERALL DIMENSIONS (mm) (continued)

■ Cat. No. 0 670 36

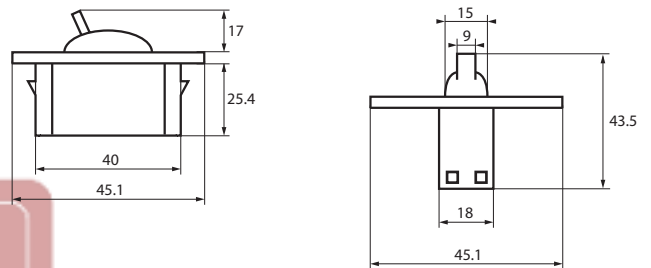

3. OVERALL DIMENSIONS (mm)

■ Cat. No. 0 670 33

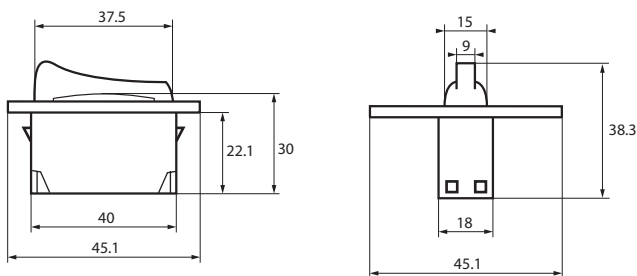

■ Cat. No. 0 670 35

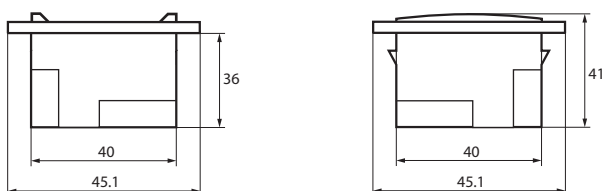

4. CONNECTION

■ Cat. No. 0 670 33/36

Automatic terminals
 Terminal capacity: 2 x 2.5 mm²
 Stripping length: 13 mm (stripping guide on the product)
 Cat. No. 0 670 36 rear view

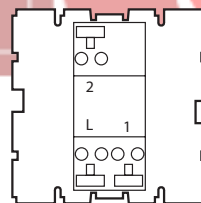

■ Cat. No. 0 670 35

Screw terminals
 Screwdriver: Posidrive 1 - Philips No 1 - Flat-blade 4 mm
 Terminal capacity: 2 x 4 mm²
 Stripping length: 11 mm (stripping guide on the product)
 Cat. No. 0 670 35 rear view

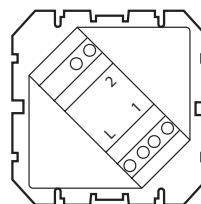

5. OPERATION

Cat. No. 0 670 33

Tilt mechanism

Cat. No. 0 670 35

ON/OFF mechanism via short press

Cat. No. 0 670 36

Lever mechanism

6. GENERAL CHARACTERISTICS

■ 6.1 Mechanical characteristics

Impact test: IK 04

Penetration against solid bodies and liquids: IP 20

Sound level Cat. No. 0 670 33 < 67 dB

■ 6.2 Material characteristics

Rocker: PBT

Mechanism: Polycarbonate

Self-extinguishing:

+ 850° C / 30 s for insulating parts holding live parts in place

+ 650° C / 30 s for other parts made of insulating materials.

■ 6.3 Electrical characteristics

Voltage: 250 V~

Current: 6 A

■ 6.4 Climatic characteristics

Use and storage temperature: - 5° C to + 35° C

7. CLEANING

Surface cleaning with a cloth.

Do not use: acetone, tar remover, trichloroethylene.

Caution: A preliminary test should be carried out if specific cleaning products are to be used.

9. STANDARDS AND APPROVALS

Compliance with standards of installation and manufacturing.

Refer to e. catalogue.