

# Plastic Under-floor boxes

Number(s) : 896 30/31/32

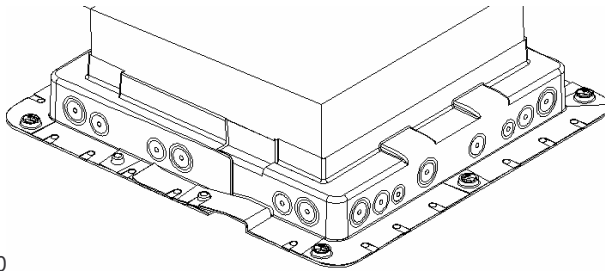

Cat Nos 896 30

**CONTENTS**
**PAGES**

- 1 Range
- 2 Fixing
- 3 Technical characteristics
- 4 Material characteristics

**1. RANGE**

Plastic under-floor boxes for concrete floor allow pouring the concrete over ICTA flexible conduits before installing floor boxes

Cat Nos	Désignations
896 30	Plastic under-floor boxes for floor boxes with height reduced to 65mm (in 10 modules) or floor boxes with height from 75 to 105mm (in 12 modules)
896 31	Plastic under-floor boxes for floor boxes with height 75 to 105mm (in 18 modules)
896 32	Plastic under-floor boxes for floor boxes with height reduced to 65mm (in 16 modules) or floor boxes with height from 75 to 105mm (in 24 modules)

Boxes are supplied with :

Polystyrene cube

4 mounting feet

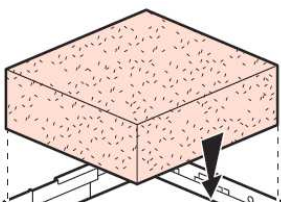

**2. FIXING.**

Directly on concrete floor :

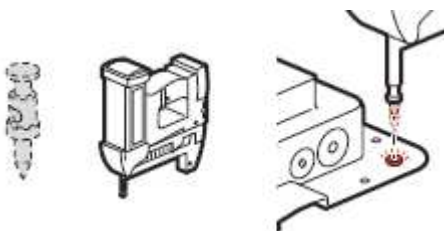
Using a spit tool with 20mm length nail :

**2. FIXING (continued)**

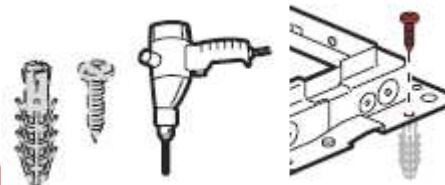
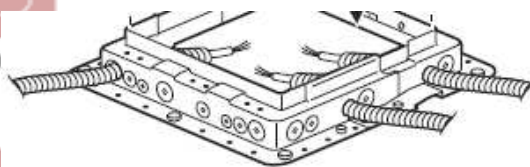
Using pins and screws of 20mm length:

**3. TECHNICAL CHARACTERISTICS.**

Plastic under-floor box is the same for the 3 Cat Nos (896 30/31/32)

Dimensions of plastic under-floor boxes :

Deep (P) can change according to the choice of plastic under-floor boxes used :

	P	L	(min)	(max)
896 30	215	255	65	120
896 31	255	255	65	120
896 32	310	255	65	120

### 3. TECHNICAL CHARACTERISTICS (continued)

Dimensions over the floor :

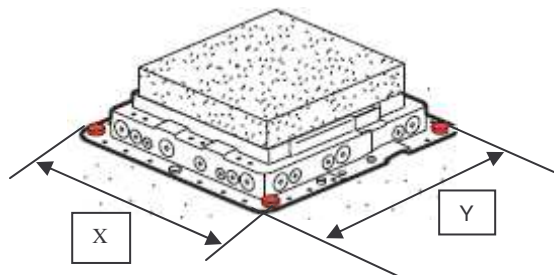

896 30 = (Y) 343 / (X) 360mm

896 31 = (Y) 383 / (X) 360mm

896 32 = (Y) 438 / (X) 360mm

Plastic under-floor boxes are equipped over 4 faces with pre-cut holes for ICTA flexible conduits (16/20 or 25mm diameter) use.

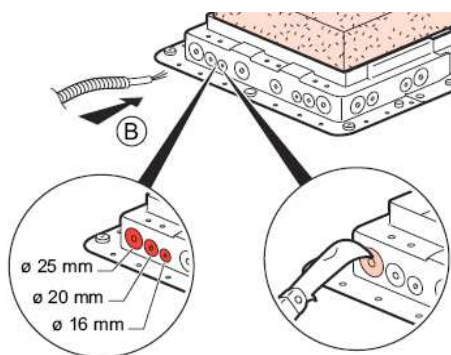

How to use mounting feet?



When height of the concrete floor (X) is between :  $90 < X \leq 120$

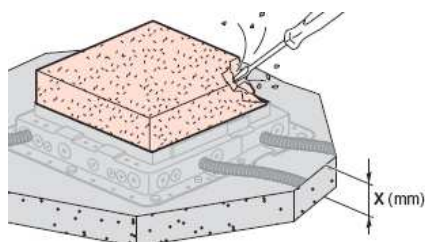

### 3. TECHNICAL CHARACTERISTICS (continued)

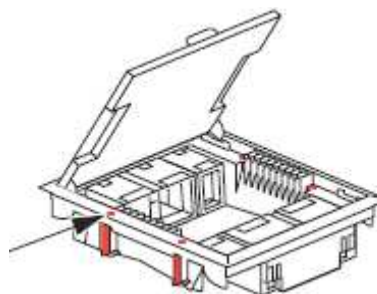

Instead of using the claws delivered with floor boxes (1) you have to use the claws delivered with plastic under-floor boxes (2).

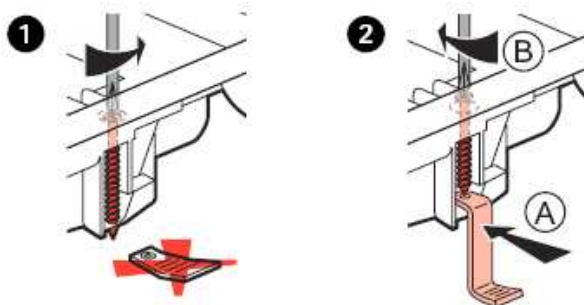

When the concrete is dry, you have to destroy the polystyrene gauge with a tool and after install the floor box.

- destroying the gauge :

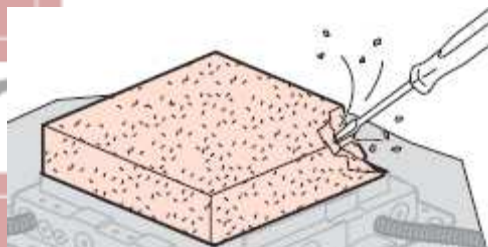

-install the floor box :

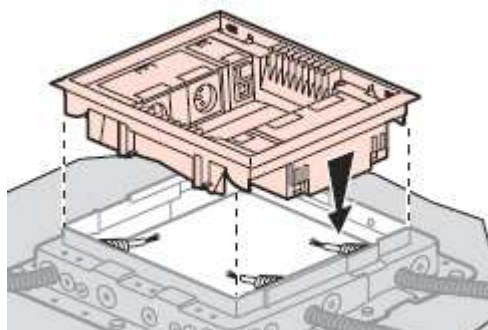

### 3. MATERIAL CHARACTERISTICS

Plastic under-floor boxes are made of grey Polypropylene.